

AMERICAN LINEAR MANUFACTURERS STANDARD HOLE PATTERN - L MODEL ENGLISH / METRIC

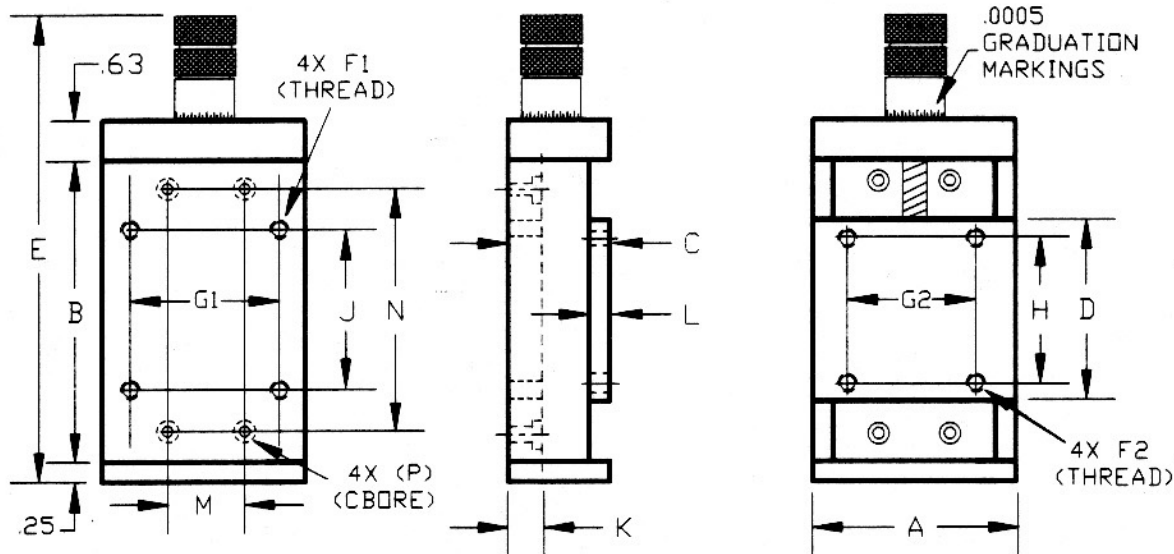

MODEL	A	B	C	D	E	F1&F2	G1&G2	H	J	K	L	M	N	P
L(A/C)2-3-1		3.00 (76.2)		2.00 (50.8)	5.5 (139.7)			1.500 (38.1)	1.500 (38.1)				2.400 (61.0)	#8 (M4)
L(A/C)2-4-1	2.00 (50.8)	4.00 (101.6)	0.98 (24.8)	3.00 (76.2)	6.5 (165.1)	8-32 (M4)	1.500 (38.1)	2.000 (50.8)	2.500 (63.5)	.330 (8.4)	.205 (5.2)	1.000 (25.4)	3.400 (86.4)	C'BORE .300 x .17 DP
L(A/C)2-6-2		6.00 (152.4)		4.00 (101.6)	8.5 (215.9)			3.000 (76.2)	4.000 (101.6)				5.000 (127.0)	
L(A/C)3-4-1		4.00 (101.6)		3.00 (76.2)	6.87 (174.4)			2.000 (50.8)	2.500 (88.9)				3.250 (82.6)	#10 (M5)
L(A/C)3-5-1	3.00 (76.2)	5.00 (127.0)	1.25 (31.7)	4.00 (101.6)	7.87 (199.8)	10-32 (M5)	2.000 (50.8)	3.000 (76.2)	3.500 (114.3)	.334 (8.5)	.405 (10.3)	1.250 (31.8)	4.250 (108.0)	C'BORE .340 x .20 DP
L(A/C)3-6-2		6.00 (152.4)		4.00 (101.6)	8.87 (225.2)			3.000 (76.2)	4.000 (127.0)				5.000 (127.0)	
L(A/C)4-6-1		6.00 (152.4)		5.00 (127.0)	8.87 (225.2)			4.000 (101.6)	3.000 (76.2)				5.250 (133.4)	#10 (M5)
L(A/C)4-8-2	4.00 (101.6)	8.00 (203.2)	1.44 (36.5)	6.00 (152.4)	10.87 (276.0)	10-32 (M5)	3.000 (76.2)	5.000 (127.0)	6.000 (177.8)	.374 (9.5)	.477 (12.1)	2.250 (57.2)	7.000 (177.8)	C'BORE .340 x .20 DP
L(A/C)4-10-2		10.00 (254.0)		8.00 (203.2)	12.87 (326.8)			6.000 (152.4)	6.000 (228.6)				9.000 (228.6)	
L(A/C)4-12-3		12.00 (304.8)		9.00 (228.6)	14.87 (377.6)			7.000 (177.8)	7.000 (254.0)				10.000 (254)	
L(A/C)6-8-2		8.00 (203.2)		6.00 (152.4)	11.37 (288.7)			4.500 (114.3)	6.000 (177.8)				7.000 (177.8)	1/4" (M6)
L(A/C)6-12-4	6.00 (152.4)	12.00 (304.8)	2.00 (50.8)	8.00 (203.2)	15.37 (390.3)	1/2-20 (M6)	4.500 (114.3)	6.000 (152.4)	8.000 (254.0)	.444 (11.3)	.804 (20.4)	3.500 (88.9)	9.000 (228.6)	C'BORE .403 x .26 DP
L(A/C)6-16-6		16.00 (406.4)		10.00 (254.0)	19.37 (491.9)			8.000 (203.2)	10.000 (304.8)				12.000 (304.8)	

DIMENSIONS IN INCHES & (MM)
SIZE DIMENSIONS ± .010 / (.25)
HOLE CENTER TO CENTER ± .005 / (.13)