

AMERICAN LINEAR MANUFACTURERS STANDARD HOLE PATTERN - X23 MODEL

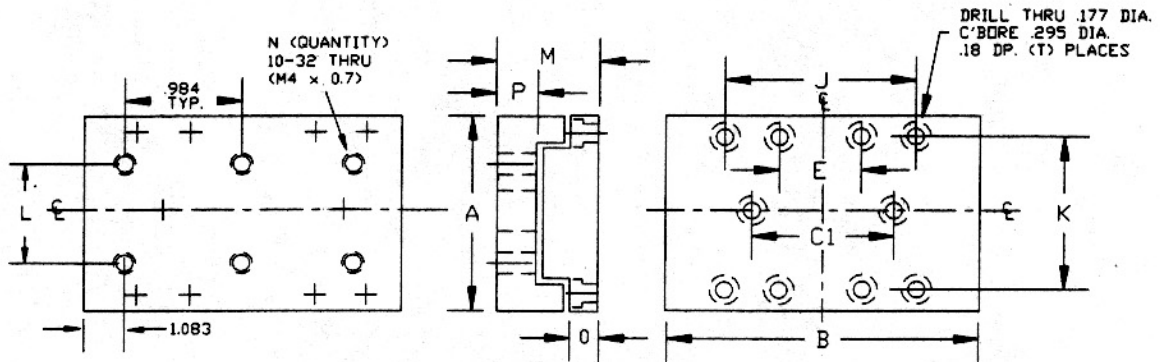

MODEL	A	B	N	T	E	C1	J	K	L	M	O	P
X(A/S)23-2-1	2.36 60.0	2.16 55.0	2	4	-	-	1.378 (35.0)	1.575 (40.0)	.984 (24.9)	1.10 (28.0)	.354 (8.99)	.384 (9.75)
X(A/S)23-3-2	2.36 60.0	3.15 80.0	4		-	-	2.362 (59.9)					
X(A/S)23-4-25	2.36 60.0	4.13 105.0	6		-	-	3.346 (84.9)					
X(A/S)23-5-3	2.36 60.0	5.12 130.0	8		-	-	4.331 (110.0)					
X(A/S)23-6-35	2.36 60.0	6.10 155.0	10		-	3.346 (84.98)	5.315 (135.0)					
X(A/S)23-7-4	2.36 60.0	7.09 180.0	12		-	4.331 (110.0)	6.299 (159.9)					
X(A/S)23-8-5	2.36 60.0	8.07 205.0	14	8	3.346 (84.98)	5.315 (135.0)	7.283 (184.9)	1.575 (40.0)	.984 (24.9)	1.10 (28.0)	.354 (8.99)	.384 (9.75)
X(A/S)23-9-6	2.36 60.0	9.05 230.0	16		4.331 (110.0)	6.299 (159.9)	8.268 (210.0)					
X(A/S)23-10-7	2.36 60.0	10.04 255.0	18		5.315 (135.0)	7.283 (184.9)	9.252 (235.0)					
X(A/S)23-11-8	2.36 60.0	11.02 280.0	20		6.299 (159.9)	8.268 (210.0)	10.236 (259.9)					
X(A/S)23-12-9	2.36 60.0	12.01 305.0	22		7.283 (184.9)	9.252 (235.0)	11.220 (284.9)					

DIMENSION IN INCHES & (MM)
SIZE DIMENSIONS ± .010 / (.25)
HOLE CENTER TO CENTER ± .005 / (.13)

REV A
4/98