

LOW PROFILE SLIDES - 118 SERIES

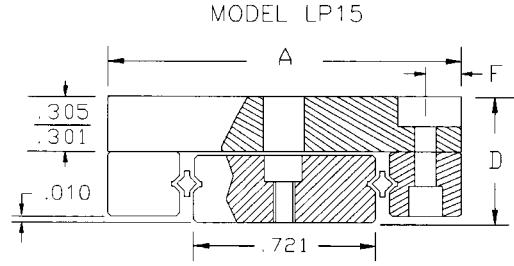
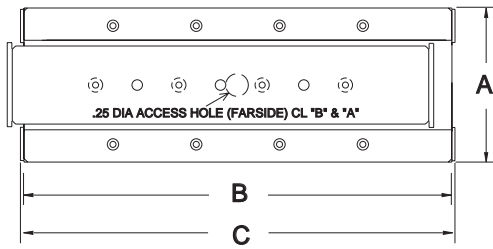

ALUMINUM TOP PLATE; HARDENED CENTER RAIL

STANDARD MOUNTING HOLES AVAILABLE.

MODEL #	A WIDTH	B PL	TRAVEL	C OAL	D HEIGHT	F	RAIL SET	WEIGHT	MAX BRG CC (LBS)	MAX ASSY CC (LBS)
LP15-2-1	1.48 37.6	2.0 50.8	1.0 25.4	2.187 55.5	0.62 15.9		DVRS118-02-6-B	0.5	174	75
LP15-3-2	1.48 37.6	3.0 76.2	2.0 50.8	3.171 80.5	0.62 15.9	.137	DVRS118-03-9-B	0.7	232	75
LP15-4-3	1.48 37.6	4.0 101.6	3.0 76.2	4.155 105.5	0.62 15.9		DVRS118-04-11-B	0.9	348	100
LP15-5-4	1.48 37.6	5.0 127.0	4.0 101.6	5.139 130.5	0.62 15.9	3.5	DVRS118-05-14-B	1.1	406	100
LP15-6-5	1.48 37.6	6.0 152.4	5.0 127.0	6.124 155.5	0.62 15.9		DVRS118-06-17-B	1.3	464	100

LP20-2-1	2.0 50.8	2.0 50.8	1.0 25.4	2.187 55.5	0.62 15.9		DVRS118-02-6-B	0.7	174	75
LP20-3-2	2.0 50.8	3.0 76.2	2.0 50.8	3.171 80.5	0.62 15.9	.397	DVRS118-03-9-B	0.9	232	75
LP20-4-3	2.0 50.8	4.0 101.6	3.0 76.2	4.155 105.5	0.62 15.9		DVRS118-04-11-B	1.1	348	100
LP20-5-4	2.0 50.8	5.0 127.0	4.0 101.6	5.139 130.5	0.62 15.9	10.1	DVRS118-05-14-B	1.3	406	100
LP20-6-5	2.0 50.8	6.0 152.4	5.0 127.0	6.124 155.5	0.62 15.9		DVRS118-06-17-B	1.5	464	100
LP20-7-6	2.0 50.8	7.0 177.8	6.0 152.4	7.180 180.5	0.62 15.9		DVRS118-07-19-B	1.6	522	100
LP20-8-7	2.0 50.8	8.0 203.2	7.0 177.8	8.092 205.5	0.62 15.9		DVRS118-08-22-B	1.8	638	100

118 SERIES (3mm) DOUBLE "V" RAIL SETS

MODEL #	D	A	B	C	F	G	H	JT	JD	NT	ND	K	M	P	L		RPR	TRAVEL		WGT
															in	mm		in	mm	
DVRS118-02	.118	.721	.322	1.476	.218	.133	.136	8-32	3mm	2	2	.492	.500 12.7	.315	1.969	50.0	8	.786	20	.25
DVRS118-03									4mm	3	2		.984 25.4		2.953	75.0	12	1.178	30	.39
DVRS118-04	3.0	18.3	8.2	37.5	5.5	3.4	3.5	*	4mm	4	3	12.5	.984 25.4	8.0	3.937	100.0	16	1.570	40	.51
DVRS118-05									4mm	5	4		.984 25.4		4.921	125.0	20	1.962	50	.62
DVRS118-06									4mm	6	5		.984 25.4		5.906	150.0	24	2.356	60	.73
DVRS118-07									4mm	7	6		.984 25.4		6.890	175.0	28	2.750	70	.84
DVRS118-08									4mm	8	7		.984 25.4		7.874	200.0	32	3.140	80	.95

*METRIC THREADS AVAILABLE UPON REQUEST

STANDARD SET INCLUDES (1) DOUBLE 'V' RAIL (2) STANDARD RAILS (2) PLASTIC ROLLER RETAINER STRIPS (6) ENDPIECES
 ROLLERS PER RETAINER MAY BE VARIED (LESS ROLLERS = INCREASED TRAVEL).

