

## PRODUCT FEATURES

60mm WIDTH x 32mm HEIGHT  
 STROKES TO 305mm (12")  
 (2) LINEAR GUIDES; (4) PUCKS (S/S)  
 NEMA 23 FRAME MOTOR MOUNT  
 M5 LOCKING STAINLESS INSERTS



## APPLICATIONS

COMPONENT POSITIONING  
 TOOLING FIXTURES  
 LASER POSITIONING  
 VISION INSPECTION / TEST & MEASUREMENT

## PRODUCT OPTIONS

HOME / LIMIT SWITCHES  
 BELLOWS / WAYCOVERS  
 NEMA 17 FRAME MOTOR MOUNT  
 IMPERIAL / ENGLISH MOUNTING HOLES  
 MULTI-AXIS CONFIGURATIONS  
 PARALLEL MOTOR MOUNTING  
 ENVIRONMENTAL PREP  
 LINEAR ENCODERS

## Performance Specifications

### Drive Screw Options

Screw Dependent	L (C7)	RB (C7)
Positional Accuracy – $\mu\text{m}/\text{mm}$ (x 0.001"/in)	6 (.00025)	20 (.0008)
Positional Repeatability – $\mu\text{m}$ (0.001")	1 (.00004)	125 (.005)
Maximum Screw Speed – RPS *	25	35
Maximum Acceleration – $\text{mm}/\text{sec}^2$ – $\text{in}/\text{sec}^2$ #	9800 (386)	19600 (770)
Drive Screw Efficiency – %	20 – 80 +	90
Drive Screw Diameter – mm (in)	9.7 (.38)	9.7 (.38)
Breakaway Torque (No Load) – N-m (oz/in)	0,056 (8)	0,042 (6)
Constant Speed Torque – N-m (oz/in)	0,042 (6)	0,028 (4)
Axial Loading – Kgf (lbs)	9 (20)	27 (60)

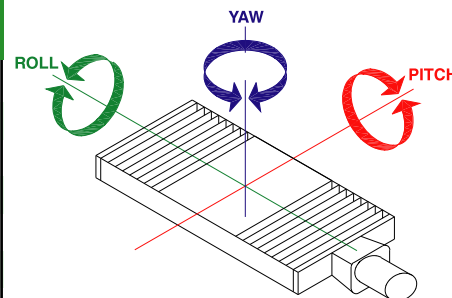

( + Fine leads minimize efficiency ) ( # Limited by maximum axial force ) ( \* Speeds may be increased with support modifications )

Stroke Length (in) Dependent	50 (.984)	100 (3.937)	150 (5.906)	200 (7.874)	250 (9.843)	300 (11.811)
Straightline Accuracy – $\mu\text{m}$ (x 0.001")^A	20 (.78)	22 (.85)	24 (.93)	40 (1.57)	45 (1.77)	50 (1.97)
Flatness of Travel – $\mu\text{m}$ (x 0.001")^A	20 (.78)	22 (.85)	24 (.93)	40 (1.57)	45 (1.77)	50 (1.97)
Table Weight – Kgf (lbs)	0,82 (1.8)	1,14 (2.5)	1,41 (3.1)	1,68 (3.7)	1,95 (4.3)	2,27 (5.0)

( ^ higher grade accuracy available. Please consult factory )

### Fixed Parameters

Static Horizontal Loading (on center) – Kgf (lbs)	40 (90)	Moment Loading (Pitch) – N-m (lb/ft)	8 (5.9)
Dynamic Horiz. Loading (on center) - Kgf (lbs)	18 (40)	Moment Loading (Yaw) – N-m (lb/ft)	8 (5.9)
Inverted Loading (on center) – Kgf (lbs)	11 (24)	Moment Loading (Roll) – N-m (lb/ft)	12 (8.8)
Per Bearing Load - Kgf (lbs)	317 (144)	Coefficient of Friction – %	0.03"
Inverted Per Bearing Load – Kgf (lbs)	317 (144)	Carriage Weight – Kgf (lbs)	0,7 (.15)

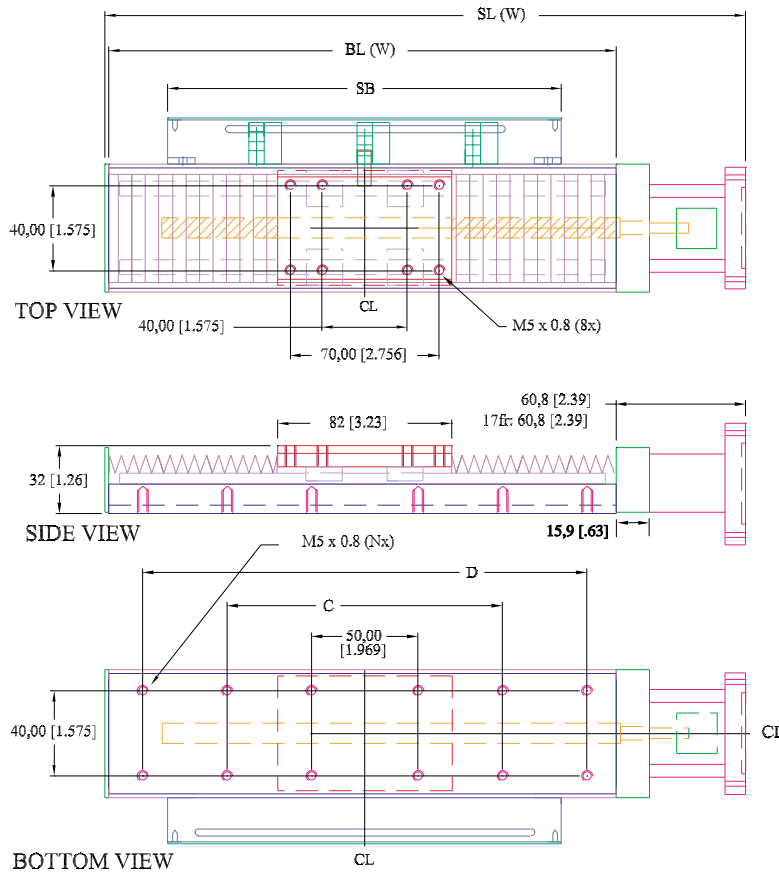

NEMA 23 MOUNT (STANDARD)

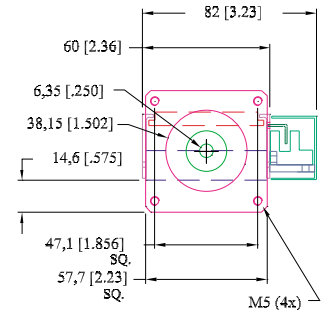

NEMA 17 MOUNT

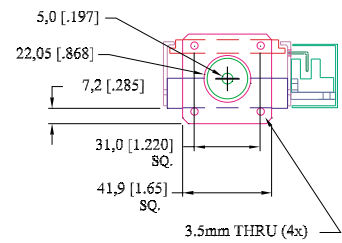

(W) = WAYCOVER OPTION  
SHOWN WITH WAYCOVER, SWITCH OPTION

STROKE	SL	SLW	BL	BLW	C	D	N	SB
51	196 (7.72)	226 (8.90)	135 (5.315)	165 (6.513)	100 (3.937)	—	8	135 (5.3)
102	246 (9.68)	299 (11.77)	185 (7.283)	238 (9.387)	150 (5.906)	—	8	185 (7.3)
153	306 (12.05)	351 (13.82)	245 (9.646)	310 (12.221)	200 (7.874)	—	8	245 (9.7)
204	366 (14.41)	421 (16.67)	305 (12.008)	360 (14.173)	150 (5.906)	250 (9.843)	12	305 (12.0)
254	411 (16.18)	466 (18.35)	350 (13.780)	405 (15.945)	150 (5.906)	300 (11.811)	12	350 (13.8)
305	456 (17.95)	511 (20.12)	395 (15.551)	450 (17.717)	200 (7.874)	350 (13.780)	12	395 (15.6)

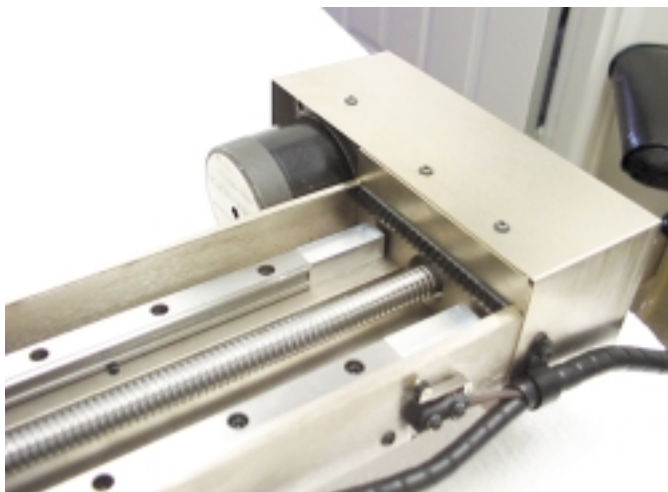

See How To Order On Page 17