

PRODUCT FEATURES

60mm WIDTH x 40mm HEIGHT
 STROKES TO 500mm (19.7")
 (1) LINEAR GUIDES; (1) PUCK (S/S)
 NEMA 17 FRAME MOTOR MOUNT
 M3 LOCKING STAINLESS INSERTS

APPLICATIONS

COMPONENT POSITIONING
 TOOLING FIXTURES
 LASER POSITIONING / WELDING
 LIGHT DUTY MACHINING
 VISION INSPECTION / TEST & MEASUREMENT
 ADHESIVE / FLUID DISPENSING

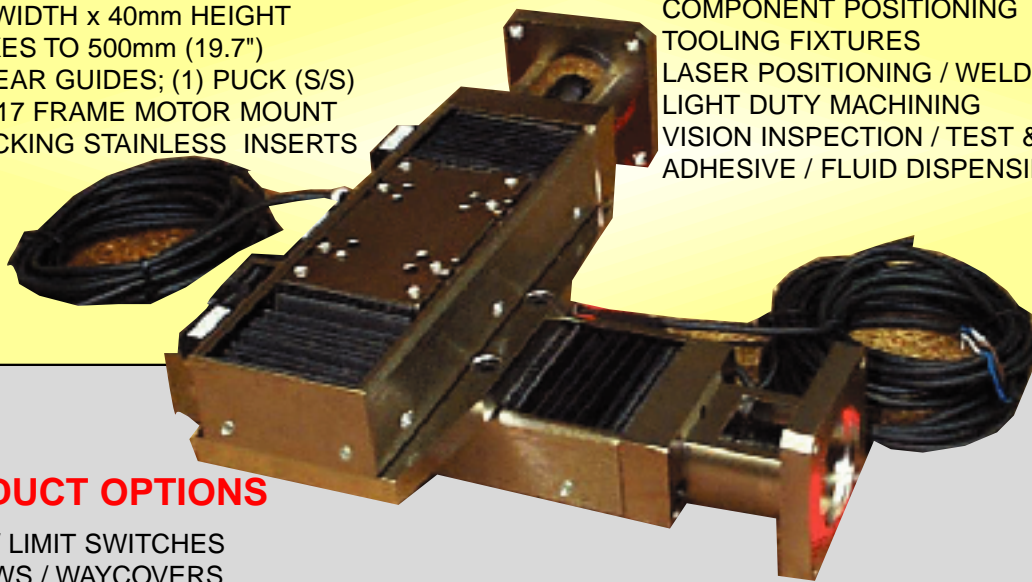

PRODUCT OPTIONS

HOME / LIMIT SWITCHES
 BELLOWS / WAYCOVERS
 NEMA 23 FRAME MOTOR MOUNT
 IMPERIAL / ENGLISH MOUNTING HOLES
 MULTI-AXIS CONFIGURATIONS
 PARALLEL MOTOR MOUNTING
 ENVIRONMENTAL PREP
 LINEAR ENCODERS

Performance Specifications

Screw Dependent	Drive Screw Options	
	L (C7)	RB (C7)
Positional Accuracy – $\mu\text{m}/\text{mm}$ (x 0.001"/in)	6 (.00025)	20 (.0008)
Positional Repeatability – μm (0.001")	1 (.00004)	125 (.005)
Maximum Screw Speed – RPS *	25	35
Maximum Acceleration – mm/sec^2 – in/sec^2 #	9800 (386)	19600 (770)
Drive Screw Efficiency – %	20 – 80 +	90
Drive Screw Diameter – mm (in)	9.7 (.38)	9.7 (.38)
Breakaway Torque (No Load) – N-m (oz/in)	0,056 (8)	0,042 (6)
Constant Speed Torque – N-m (oz/in)	0,042 (6)	0,028 (4)
Axial Loading – Kgf (lbs)	9 (20)	27 (60)

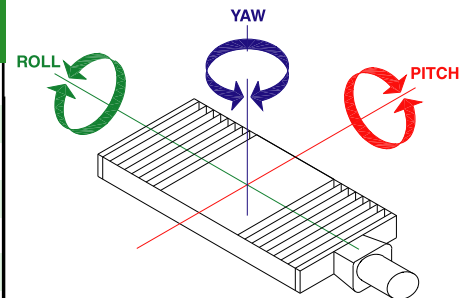

(+ Fine leads minimize efficiency) (# Limited by maximum axial force) (* Speeds may be increased with support modifications)

Stroke Length (in) Dependent	50 (1.969)	100 (3.937)	150 (5.906)	200 (7.874)	250 (9.843)	300 (11.811)	350 (13.780)	400 (15.748)
Straightline Accuracy – μm (x 0.001")^A	18 (.71)	20 (.78)	24 (.94)	40 (1.57)	50 (1.97)	70 (2.75)	80 (3.15)	100 (3.94)
Flatness of Travel – μm (x 0.001")^A	18 (.71)	20 (.78)	24 (.94)	40 (1.57)	50 (1.97)	70 (2.75)	80 (3.15)	100 (3.94)
Table Weight – Kgf (lbs)	1,2 (2.6)	1,3 (3.0)	1,5 (3.3)	1,6 (3.7)	1,9 (4.3)	2,1 (4.7)	2,3 (5.2)	2,5 (5.6)

(^ higher grade accuracy available. Please consult factory)

Fixed Parameters

Static Horizontal Loading (on center) – Kgf (lbs)	45 (100)	Moment Loading (Pitch) – N-m (lb/ft)	33.3 (24)
Dynamic Horiz. Loading (on center) - Kgf (lbs)	31 (70)	Moment Loading (Yaw) – N-m (lb/ft)	33.3 (24)
Inverted Loading (on center) – Kgf (lbs)	11 (25)	Moment Loading (Roll) – N-m (lb/ft)	52.0 (38)
Per Bearing Load - Kgf (lbs)	478 (1,056)	Coefficient of Friction – %	0.02"
Inverted Per Bearing Load – Kgf (lbs)	478 (1,056)	Carriage Weight – Kgf (lbs)	0,09 (.20)

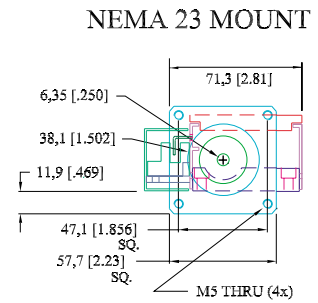
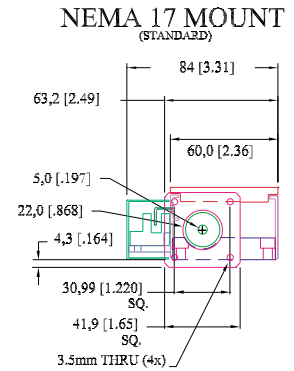
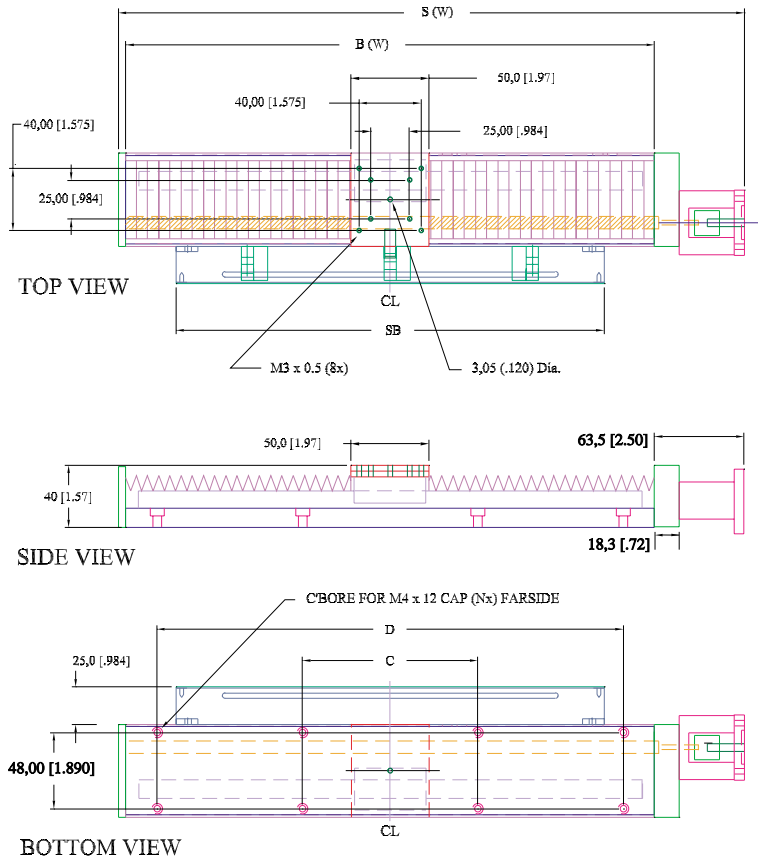

(W) = WAYCOVER OPTION
SHOWN WITH WAYCOVER, (SOS) SWITCH OPTION

STROKE	S	SW	B	BW	C	D	N	SB
50	170 (6.69)	210 (8.27)	100 (3.937)	140 (5.51)	80 (3.150)	—	4	100 (3.9)
100	220 (8.66)	270 (10.63)	150 (5.906)	200 (7.87)	100 (3.937)	—	4	150 (5.9)
150	270 (10.63)	310 (12.20)	200 (7.874)	250 (9.843)	150 (3.937)	—	4	200 (7.9)
200	320 (12.60)	400 (15.75)	250 (9.843)	330 (12.99)	80 (3.150)	200 (7.874)	8	250 (9.5)
250	370 (14.57)	450 (17.72)	300 (11.811)	380 (14.96)	100 (3.937)	250 (9.843)	8	300 (11.8)
300	420 (16.54)	510 (20.08)	350 (13.780)	450 (17.72)	150 (5.906)	300 (11.811)	8	350 (13.8)
350	470 (18.50)	570 (22.44)	400 (15.748)	500 (19.69)	150 (5.906)	350 (13.780)	8	400 (15.8)
400	510 (20.08)	650 (25.59)	450 (19.291)	580 (22.83)	150 (5.906)	400 (15.748)	8	450 (19.3)
500	620 (24.41)	770 (30.31)	550 (21.654)	700 (27.56)	200 (7.874)	500 (19.685)	8	550 (21.7)

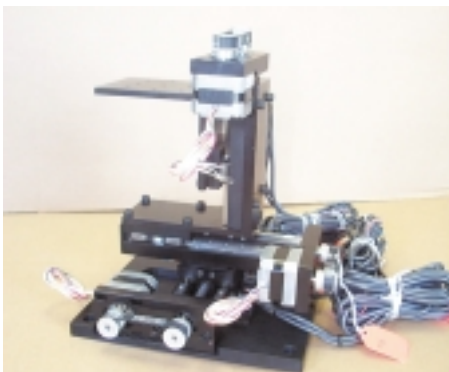

See How To Order On Page 17